

GENERAL

- 1. ALL WORK SHALL BE DONE IN ACCORDANCE WITH THE SPECIFICATIONS AND/OR REQUIREMENTS OF KUNA CITY PUBLIC WORKS DEPARTMENT...

ROADWAY

- 1. ALL CONSTRUCTION IN THE PUBLIC RIGHT-OF-WAY SHALL CONFORM TO THE 2002 EDITION OF THE ISPMC AND THE ACHD SUPPLEMENTAL SPECIFICATIONS...

SEWER

- 1. ALL WORK SHALL BE DONE IN ACCORDANCE WITH THE (2002) SEWER SPECIFICATIONS AND STANDARD DRAWINGS OF THE IDAHO STANDARDS FOR PUBLIC WORKS CONSTRUCTION (ISPMC)...

SEWER (CONT'D)

- 9. THE PAVING CONTRACTOR SHALL SET THE GRADE RINGS AND POUR THE CONCRETE COLLARS PER STANDARD DRAWING NO. SD 508...

WATER

- 1. THE WATER SYSTEM SHALL BE CONSTRUCTED TO CONFORM WITH THE STANDARDS SET FORTH IN THE "IDAHO REGULATIONS FOR PUBLIC DRINKING WATER SYSTEMS"...

WATER (CONT'D)

- 20. ALL FIRE HYDRANTS SHALL BE DRY BARREL FIRE HYDRANTS CONFORMING TO AWWA C-502. HYDRANTS SHALL HAVE A FIVE (5) FOOT SETTING...

GENERAL LEGEND

Legend table with symbols and descriptions: SB - EXISTING SEWER LINE (PIPE SIZE), WB - EXISTING WATER LINE (PIPE SIZE), S - NEW SEWER LINE (8" UNLESS NOTED)...

DEVELOPMENT PLANS FOR SABLE RIDGE SUBDIVISION NO. 2

LOCATED IN THE SW 1/4 OF SECTION 13 TOWNSHIP 2 NORTH, RANGE 1 WEST, BOISE MERIDIAN KUNA, ADA COUNTY, IDAHO 2003

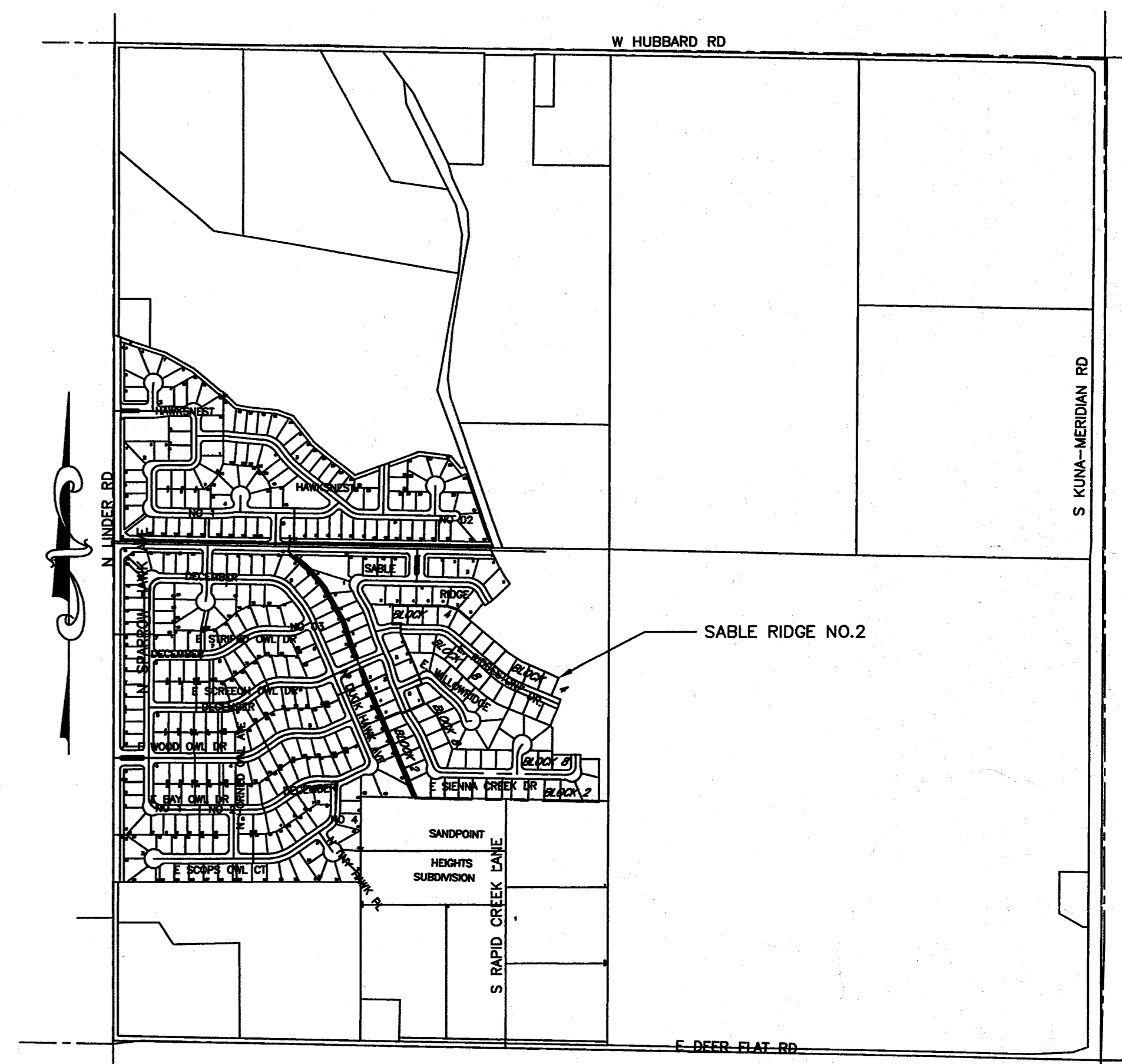

VICINITY MAP

1" = 600'

RECORD DRAWING 08-22-03

PLAN SHEET INDEX

Table with 2 columns: SHEET and DESCRIPTION. Rows include: 1 - COVER SHEET, INDEX, VICINITY MAP, & NOTES; 2 - FINAL PLAT; 3 - COOL SPRINGS, SIENNA CREEK, RIDGECREEK, SUMMERWIND STREET PLAN AND PROFILE...

Project information box including: REVISED table, DRAWN BY: DAB, CHECKED BY: DAVID A. BAILEY P.E., PROJECT NO. C22022, DATE: 12-09-02, and Bailey Engineering logo with contact info.









