

TOMORROW SUBDIVISION NO. 1

KUNA, ADA COUNTY, IDAHO

Certification of this set of RECORD DRAWINGS pertains only to the horizontal and vertical locations of sanitary sewer manholes and horizontal locations of potable water valves.

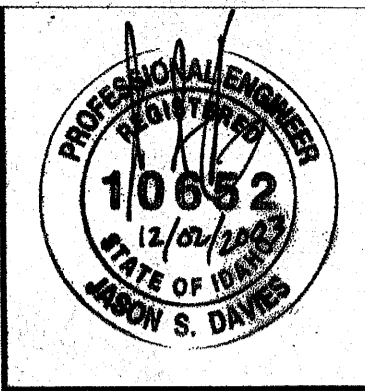
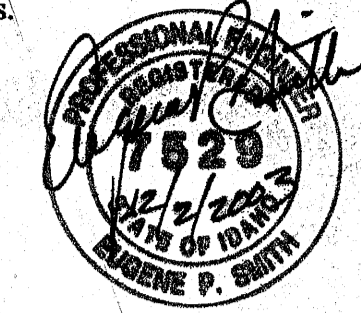

TOMORROW SUBDIVISION NO. 1

-INDEX OF PLAN SHEETS-

SHEET	DESCRIPTION
1	COVER SHEET
2	GENERAL NOTES
3	SEWER PLAN & PROFILE INDEX
4	STREET PLAN & PROFILE INDEX
5	STREET PLAN & PROFILE (N. KAY AVE.)
6	STREET PLAN & PROFILE (E. LIMESTONE ST. & N. QUARTZ PL.)
7	STREET PLAN & PROFILE (N. MUDSTONE WAY)
8	STREET PLAN & PROFILE (E. SEAHOLLY ST., N. QUARTZ ST. & E. PLUTON DR.)
9	STREET PLAN & PROFILE (E. KEROGEN CT. & N. LAHAR PL.)
10	STREET/DRAINAGE & TEED LATERAL CROSSING DETAILS
11	SEWER PLAN & PROFILE (LINE A & LINE B)
12	SEWER PLAN & PROFILE (LINE C)
13	SEWER PLAN & PROFILE (LINE D)
14	SEWER PLAN & PROFILE (LINE E & LINE F)
15	WATER PLAN
16	PRESSURE & GRAVITY IRRIGATION PLAN
17	PRESSURE & GRAVITY IRRIGATION DETAILS
18	PARKING LOT GRADING PLAN
19	CULVERT DETAIL

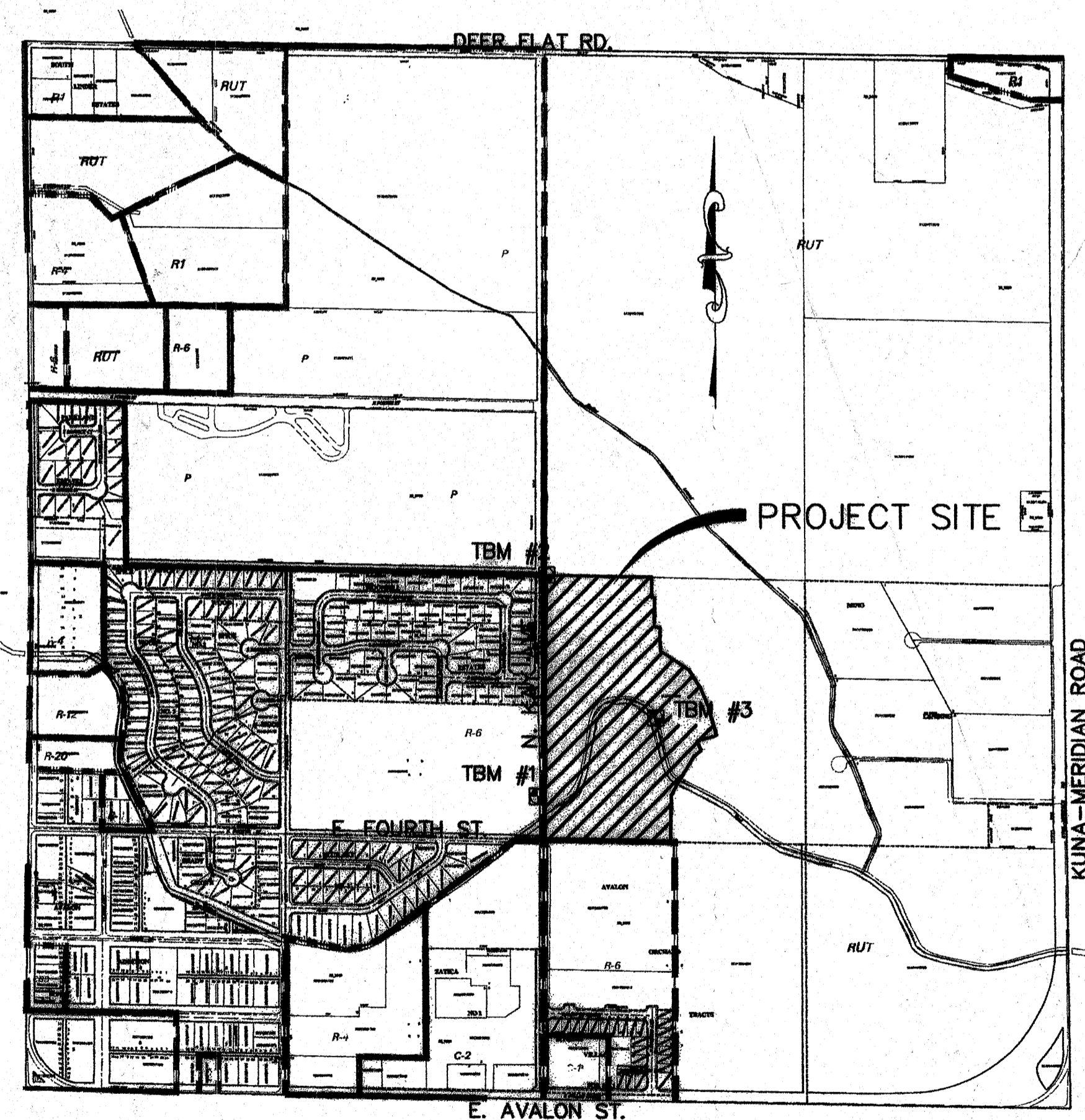

VICINITY MAP
-NTS-

BENCH MARK:

- TBM #1 EL. = 2711.05
CHISELED SQUARE IN TOP BACK OF CURB, WEST SIDE OF N. KAY AVE.
- TBM #2 EL. = 2698.40
FOUND BRASS CAP C1/4 CORNER OF SECTION 24, T.2N., R.1W., B.M.
- TBM #2 EL. = 2719.08
TOP NORTH CORNER OF CONCRETE HEADWALL.

+3.19' = NAVD 88 DATUM

THESE DRAWINGS, OR ANY PORTION THEREOF, SHALL NOT BE USED ON ANY PROJECT OR EXTENSIONS OF THIS PROJECT EXCEPT BY AGREEMENT IN WRITING WITH ENGINEERING NORTHWEST, LLC.

NO.	REVISIONS	BY	DATE	REV. COGO FILE	DATE

J:\TOMORROW_1_0200900\Drawings\ASBUILTS\01_TOMORROW_1_COVER_ASBUILTS.dwg 11/18/2003 9:45:58 AM MST

Engineering NorthWest, LLC

423 N. ANCESTOR PL.
SUITE 180
BOISE, IDAHO 83704
(208)376-5000

TOMORROW SUBDIVISION NO. 1

RECORD DRAWING

COVER SHEET

JOB NO.
02-009-00

SHEET NO.
1

